

# dicken™ PITLESS ADAPTERS Made in the USA



## Features:

- Precision machined all red brass castings with neoprene O-ring
- Large inner and outer rubber gaskets to seal out surface water contamination
- All Dicken pitless adapters are pressure tested to 150 psi
- Chamfered slide for fast and easy installation
- Wrench grip on ell speeds installation
- A built in lowering eyelet for easier installation
- Water System Council - PAS-97 (04) listed

Part Number	Model	Discharge Pipe (Inches)	Supply Pipe (Inches)	Casing Size, (Inches) I.D. / O.D.	Hole Size, Required (Inches)	Shipping Weight (lbs-oz.)	Working Load (lbs)	Quantity /Carton
952156	JR-S-10	1	1	4 1/2 to 12	1 5/8	2 lbs. 5 oz.	1500	12
952158	*JR-S-10-P	1	1	4 1/2 to 12	1 5/8	2 lbs. 5 oz.	1500	12
952110	LD-S-10	1	1	5 to 12	1 3/4	4 lbs. 2 oz.	2000	12
952160	*LD-S-10-P	1	1	5 to 12	1 3/4	4 lbs. 3 oz.	2000	12
952112	LD-S-12	1 1/4	1 1/4	5 to 12	2 1/4	5 lbs. 8 oz.	2000	8
952162	*LD-S-12-P	1 1/4	1 1/4	5 to 12	2 1/4	5 lbs. 9 oz.	2000	8
952010	S-10	1	1	5 to 12	1 3/4	5 lbs.13 oz.	5000	8
952012	S-12	1 1/4	1 1/4	5 to 12	2 1/4	8 lbs. 2 oz.	5000	6
952015	S-15	1 1/2	1 1/2	5 to 12	2 5/8	10 lbs.12 oz.	5000	6
952020	S-20	2	2	5 5/8 to 12	3 1/8	14 lbs. 4 oz.	5000	4
952150	LD-2-X upper lower	1 1/4 1	1 1/4 1	4 1/2 to 12	2 1/4 1 1/4	11 lbs. 9 oz.	2000	6

- Pressurized model available for counties and states where required.
- JR-S-10 may be used on 4" casing with 3" pump.

## CLEARWAY PITLESS ADAPTER Patented

- Features:
- Simple slip fit insert
  - Easy installation by cutting 2 3/4" hole and clamping on
  - Clamp on units for no obstruction in well casing ID

Part Number	Model	Discharge Pipe (Inches)	Supply Pipe (Inches)	Casing Size (Inches) I.D. / O.D.	Hole Size Required (Inches)	Shipping Weight (lbs-oz.)	Working Load (lbs)	Quantity /Carton
952040	CW-4-10	1	1	4 4 1/2	2 3/4	5 lbs. 1 oz.	2000	6
952050	CW-5-10	1	1	4 1/2 5 5 9/16	2 3/4	5 lbs. 0 oz.	2000	6
952060	CW-6-10	1	1	5 5/8 6 6 5/8	2 3/4	5 lbs. 14 oz.	2000	6
952045	CW-4-10-WA	1	1	4 4 1/2	2 3/4	6 lbs. 0 oz.	2000	6
952047	CW-4.5-10-WA	1	1	4 1/2 5	2 3/4	6 lbs. 8 oz.	2000	6
952055	CW-5-10-WA	1	1	5 5 9/16	2 3/4	6 lbs. 8 oz.	2000	6
952065	CW-4-12-WA	1 1/4	1 1/4	4 4 1/2	2 3/4	6 lbs. 5 oz.	2000	6
952066	CW-4.5-12-WA	1 1/4	1 1/4	4 1/2 5	2 3/4	6 lbs. 12 oz.	2000	6
952067	CW-5-12-WA	1 1/4	1 1/4	4 1/2 5 6 6 5/8	2 3/4	6 lbs. 5 oz.	2000	6
952058	CW-6-12-WA	1 1/4	1 1/4	5 5/8 6 6 5/8	2 3/4	6 lbs. 15 oz.	2000	6
952075	CW-4-12 -25PW	1 1/4	1 1/4	4 4 1/2	2 3/4	6 lbs. 5 oz.	2000	6
952076	CW-5-12 -25PW	1 1/4	1 1/4	4 1/2 5 5 9/16	2 3/4	6 lbs. 5 oz.	2000	8
952077	CW-6-12 -25PW	1 1/4	1 1/4	5 5/8 6 6 5/8	2 3/4	6 lbs. 15 oz.	2000	6

- Features:
- Pressurized for use in Michigan
  - Designed for 4" or 5" well casing
  - Fits Schedule 40 through SDR21
  - Unit comes complete with WTTC Michigan Approved cap as described on Page 14

Part Number	Model	Discharge Pipe (Inches)	Supply Pipe (Inches)	Casing Size (Inches) I.D. / O.D.	Shipping Weight (lbs-oz.)	Working Load (lbs)	Quantity /Carton
952043	CW-4-10-25P W/4 WTCC CAP	1	1	4 4 1/2	7.3	2000	1
952053	CW-5-10-25P W/5 WTCC CAP	1	1	5 5 9/16	9.8	2000	1

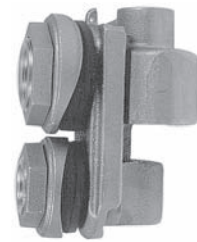

DICKEN PITLESS ADAPTERS

# PITLESS ADAPTER "O" RINGS

## PITLESS ADAPTER "O" RINGS

<b>dicken™ SERIES</b>		
<b>PART #</b>	<b>SIZE</b>	<b>LIST PRICE</b>
017304	JR-S10	See separate price list
017304	LDS-10	
017315	LDS-12	
017300	S-10	
017315	S-12	
017325	S-20	
017300	LD-2X	
018315	CW-4-10	
018315	CW-5-10	
018315	CW-6-10	
018315	CW-4-10WA	
018315	CW-4.5-10WA	
018315	CW-5-10WA	

<b>MAASS J-JX-JC SERIES</b>		
<b>PART #</b>	<b>SIZE</b>	<b>LIST PRICE</b>
001030	J1	See separate price list
001030	JC 1 1/4	
001032	J1 1/4	
001032	J1 1/2	
001034	J2	
001036	J2 1/2	
001038	J3	
001040	J4	
990000	Model J O-Ring Repair Kit	

**NOTE:** Model J O-Ring Repair Kit contains: 12 pcs. J1 O-Rings,  
6 pcs. J1<sup>1/4</sup> / J1<sup>1/2</sup> O-Rings and 3 pcs. J2 O-Rings.

<b>MAASS MODEL MB UNITS</b>		
<b>PART #</b>	<b>SIZE</b>	<b>LIST PRICE</b>
001008	8" MB HD	See separate price list
001010	10" MB HD	
001012	12" MB HD	
001014	14" MB HD	
001016	16" MB HD	
001018	18" MB HD	
001020	20" MB HD	
001022	22" MB HD	
001024	24" MB HD	

PITLESS ADAPTER "O" RINGS

